

1.0 GENERAL REQUIREMENTS

- 1.1 **PERMITS** A Mutual permit is required for all alterations to the building. County of Orange permit is also required. All fees for both mutual and county permits shall be paid for by the member and/or the contractor. Member and/or contractor must supply Planning and Engineering Services department with County permit number prior to beginning work.
- 1.2 **MEMBER RESPONSIBILITY** The member is solely responsible for the maintenance, repair, and replacement of all alterations to the building.
- 1.3 **CODES AND REGULATIONS** All work shall comply with all applicable local, state, and federal requirements including but not limited to the current edition of the Uniform Building Code.
- 1.4 **WORKING HOURS** No work shall commence prior to 7:00 a.m. and no work shall be performed after 6:00 p.m. Working through Friday, Saturday work shall be held to a minimum and no work shall be performed on Sunday.
- 1.5 **DUMPSTERS** The premises shall be kept free from accumulation of waste materials and/or rubbish caused by the construction work. Member and/or contractor is responsible for removal of debris and excess material and must leave work areas "ROOM CLEAN" daily. **USE OF COMMERCIAL DUMPSTERS FOR CONSTRUCTION RELATED DUMPING IS NOT PERMITTED.** Dumpsters, if required, must have location approved by Planning and Engineering Department. Waste disposal company must be the same company that services the Leisure World Community.
- 1.6 **WARRANTY** Skylight installer shall guarantee the skylight's watertight integrity of skylight and roof for five (5) years from date of installation and shall repair without charge to owner any such defects.
- 1.7 **PLANS** The member and/or contractor applying for permit is responsible for following the **PERMITS, SPECIFICATIONS PLAN** AND **SPECIFICATIONS**. Dimensions on plan shall govern over scale.

2.0 APPLICATIONS

- 2.1 **OPERATIONS** Any skylight installed may be of an "OPERABLE" type.
- 2.2 **INTERIOR FINISH** Interior Finish, such as open well or luminous panel ceiling, is optional. Size of opening at ceiling is optional unless otherwise noted. Skylight wells and all exposed wood to be drywalled and taped with one (1) hour fire rated material. Insulate the four (4) side walls of well with minimum R-19 insulation.
- 2.3 **MATERIALS** All materials shall be of standard grade or better unless otherwise noted.
- 2.4 **MANUFACTURER'S DIRECTIONS** Where manufacturer's directions/specifications are called for they shall be considered as part of these drawings and modifications.
- 2.5 **ELECTRICAL** Electrical fixtures may be placed inside wells providing they meet the latest edition of the National Electric Code.

3.0 INSTALLATION

- 3.1 **MOUNTING** Skylight shall be mounted on 2 x 8 curb. On Tile and Metal roofs skylights shall be mounted on a 2 x 8 curb. Mounting of dome shall be with galvanized or equal head screws to aid in removal during re-roofing. **NO SELF-FLASHING SKYLIGHTS SHALL BE ALLOWED.**
- 3.2 **OBSTACLES** No skylight shall be installed within twelve (12) inches of any vent ridge or vertical members or edge of roof.
- 3.3 **SKYLIGHTS** All skylights shall be L.C.B.O. approved and be of double lens construction.
- 3.4 **COLOR** Skylights shall be keeping with the architecture of the building with the following restrictions:
 - 3.41 **UNITED L.I.M.** All skylights installed shall be off-white color and/or shall match existing.
 - 3.42 **THIRD L.I.M.** Skylights may be either off-white or cream-colored in color and/or match existing skylights on building.
- 3.5 **TRUSSES** No structural member such as truss shall be cut or altered.

4.0 PATIO COVERS

- 4.1 **INSTALLATION** Skylights shall be permitted in the roofs of solid wood patio covers only.
- 4.2 **SIZE** No skylights shall be larger than 4'-0" x 4'-0".
- 4.3 **LOCATION** One skylight shall be permitted per 10 L.F. of patio cover width. All skylights shall be equally spaced and centered in the run.

5.0 CONSTRUCTION NOTES

- 5.1 **TYPE OF ROOFING** V-N
- 5.2 **TYPE OF ROOFING** R-1
- 5.3 **ROOFING MATERIAL** skylight roof material tie-in w/ existing built-up roofs (GOLD PROCESS) materials required per 100 square feet of roof area shall be as follows:

5.31 CONCRETE, 1 1/2" thick, 1 ply	20lbs
5.32 CONCRETE, 3 ply	50lbs
5.33 CONCRETE, 6 gal @ 8 lbs/gal	48lbs
5.34 CONCRETE, for MB CAP, 2 gal	70lbs
5.35 MB CAP surfacing sheet	75lbs

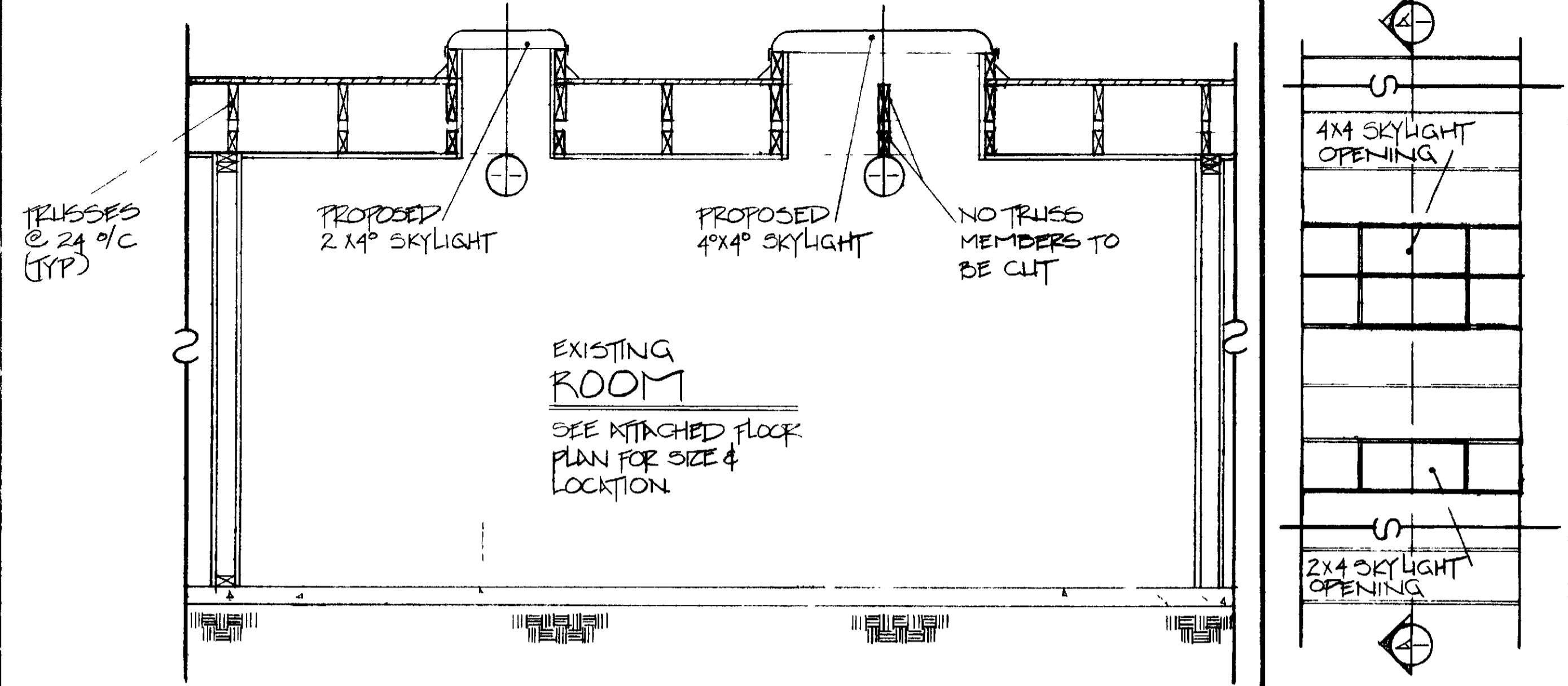

SECTION TYPICAL ROOM W/ SKYLIGHT SCALE 1/2" = 1'-0"

SCALE NONE FRAMING PLAN

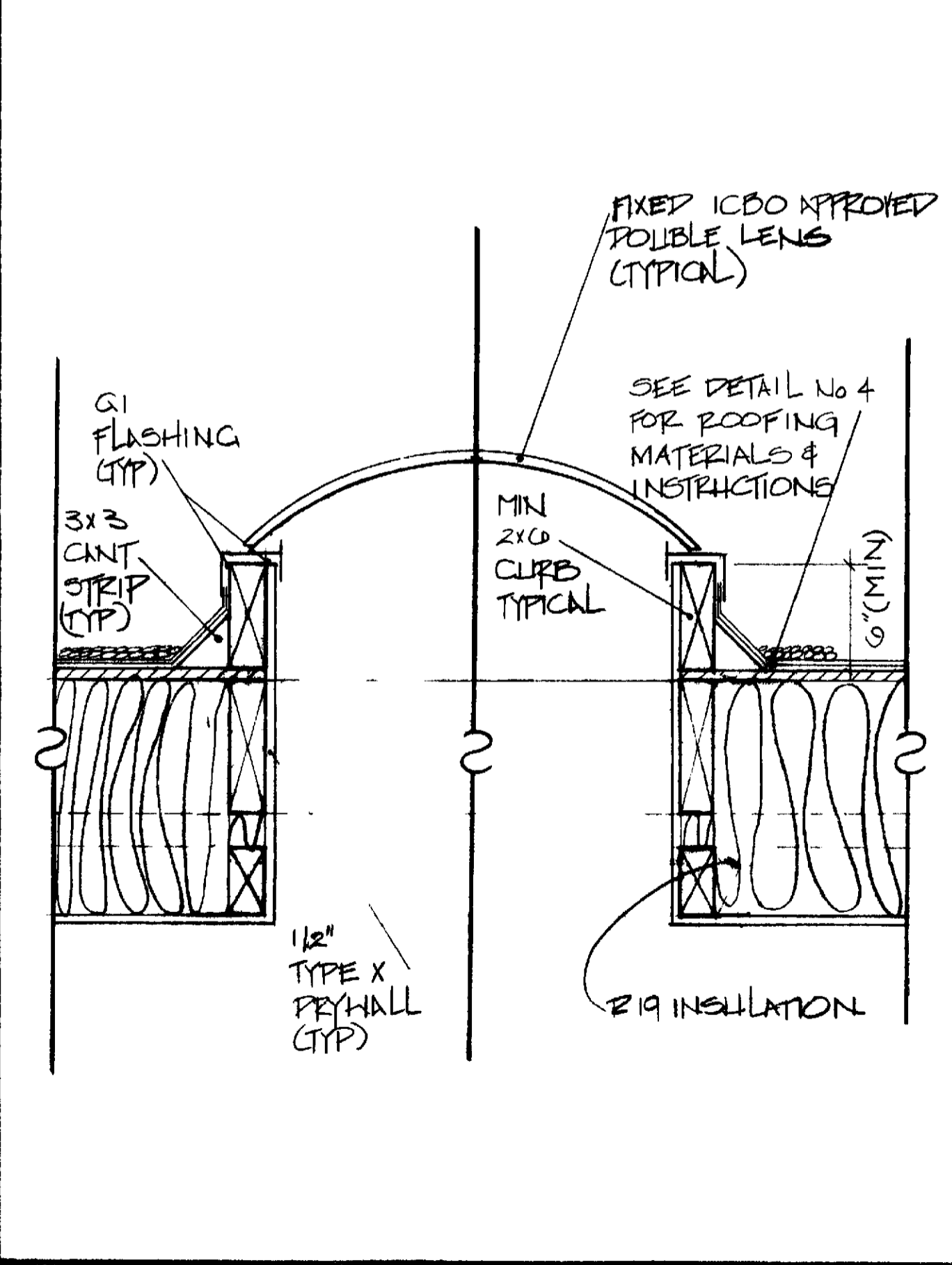

DETAIL SKYLIGHT SCALE 1-1/2" = 1'-0"

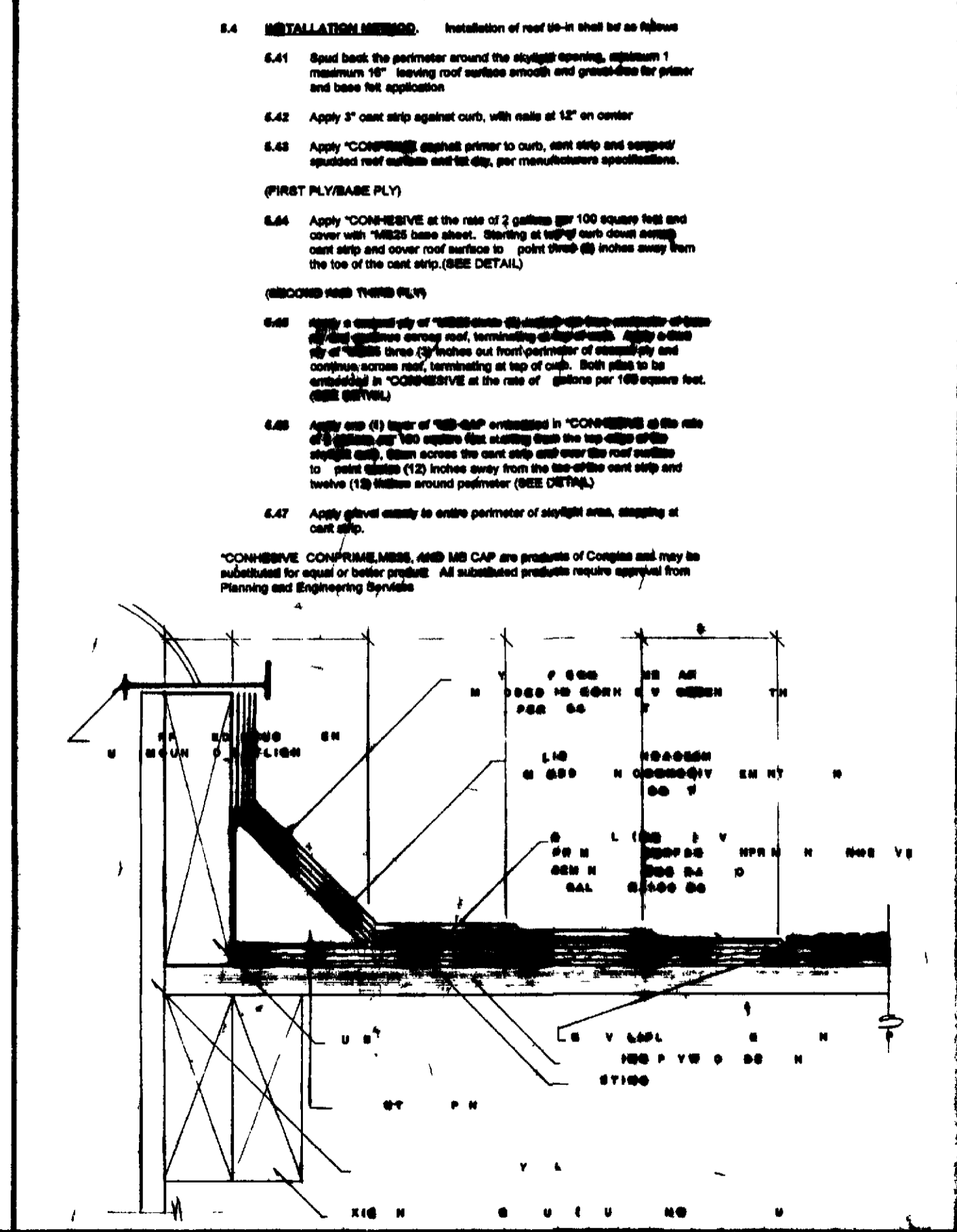

DETAIL SKYLIGHT ROOFING

GENERAL NOTES



TYPICAL SKYLIGHT PLAN FLAT ROOF

REVISIONS

NO.	DATE
1	4/10/91
2	4/10/91

DRAWN BY
G. OSWALD

DATE
4/10/91

APPROVAL
[Signature]

Laguna Woods Village
STANDARD PLAN NO 255