

GENERAL NOTES

- 1) Dimensions have preference over scale
- 2) Contractor shall verify all dimensions & conditions @ each job site prior to commencing construction
- 3) Contractor shall secure and pay for all permits reqd by P C M Inc & Orange County Bldg Dept
- 4) Line 11 skylight areaways w/drywall
- 5) All phases of construction shall comply w/ CURRENT Ed of the U B C and/or state & local codes
- 6) Upon completion contractor shall remove all debris & excess material & leave areas of work broom clean
- 7) All fasteners exposed to weathering shall be corrosive resistant or galvanized metal
- 8) Skylight shall be I C B O 10 1998 approved it
- 9) Framing Lumber
Horizontal D F - L #2
Vertical D F - L #2 (or better)
- 10) Type of construction V N
- 11) Group of occupancy R 1
- 12) Contractor to furnish additional structural drawings and calculations requested by building official
- 13) NO SELF FLASHING SKYLITES ALLOWED NO EXCEPTIONS
- 14) ALL SKYLITES SHALL BE FASTENED WITH CAP SCREWS NAILS ARE NOT PERMISSIBLE
- 15) ALL SKYLITES SHALL BE REQUIRED TO HAVE A MINIMUM OF 3/2" CLEARANCE ABOVE THE ROOF

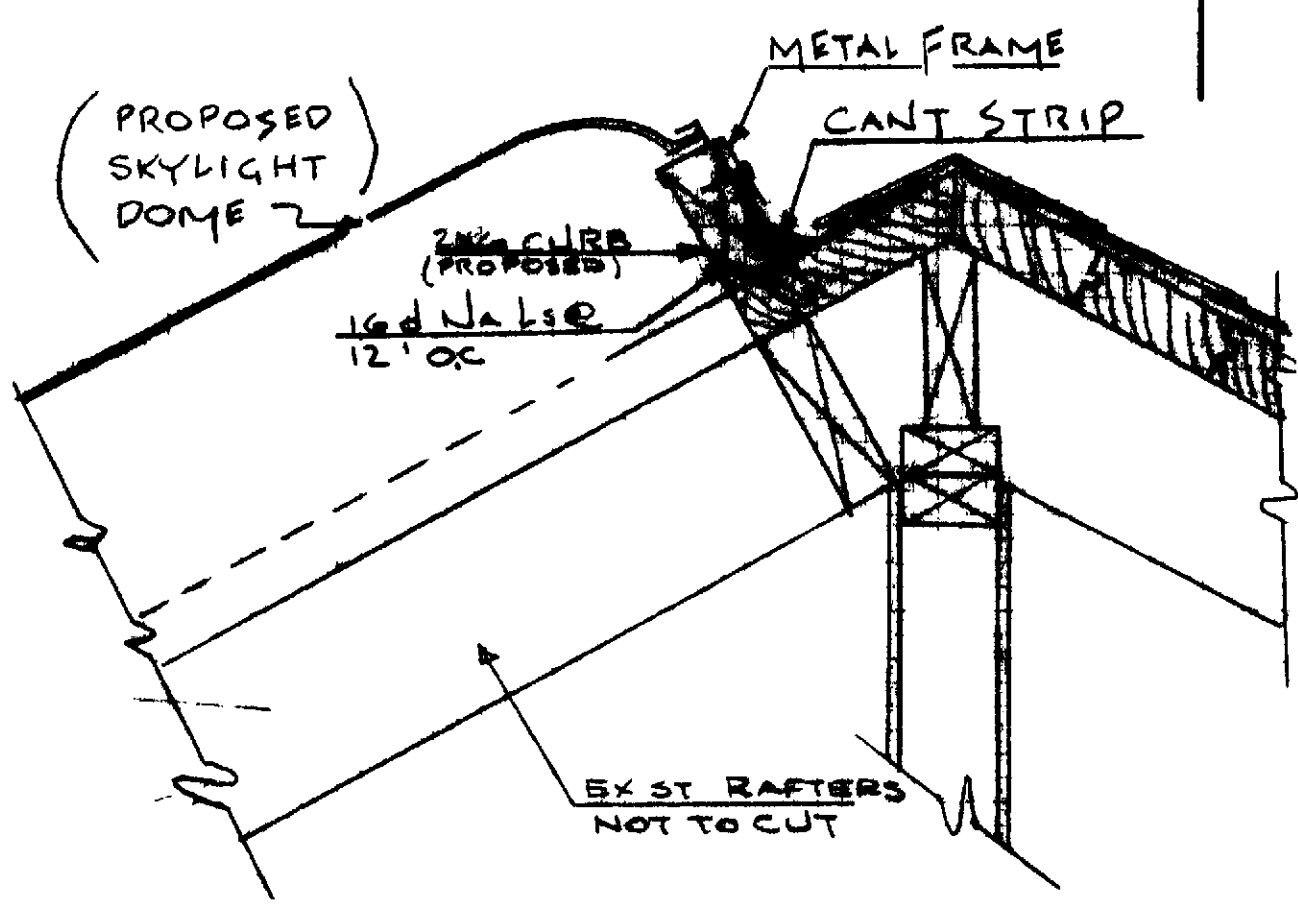
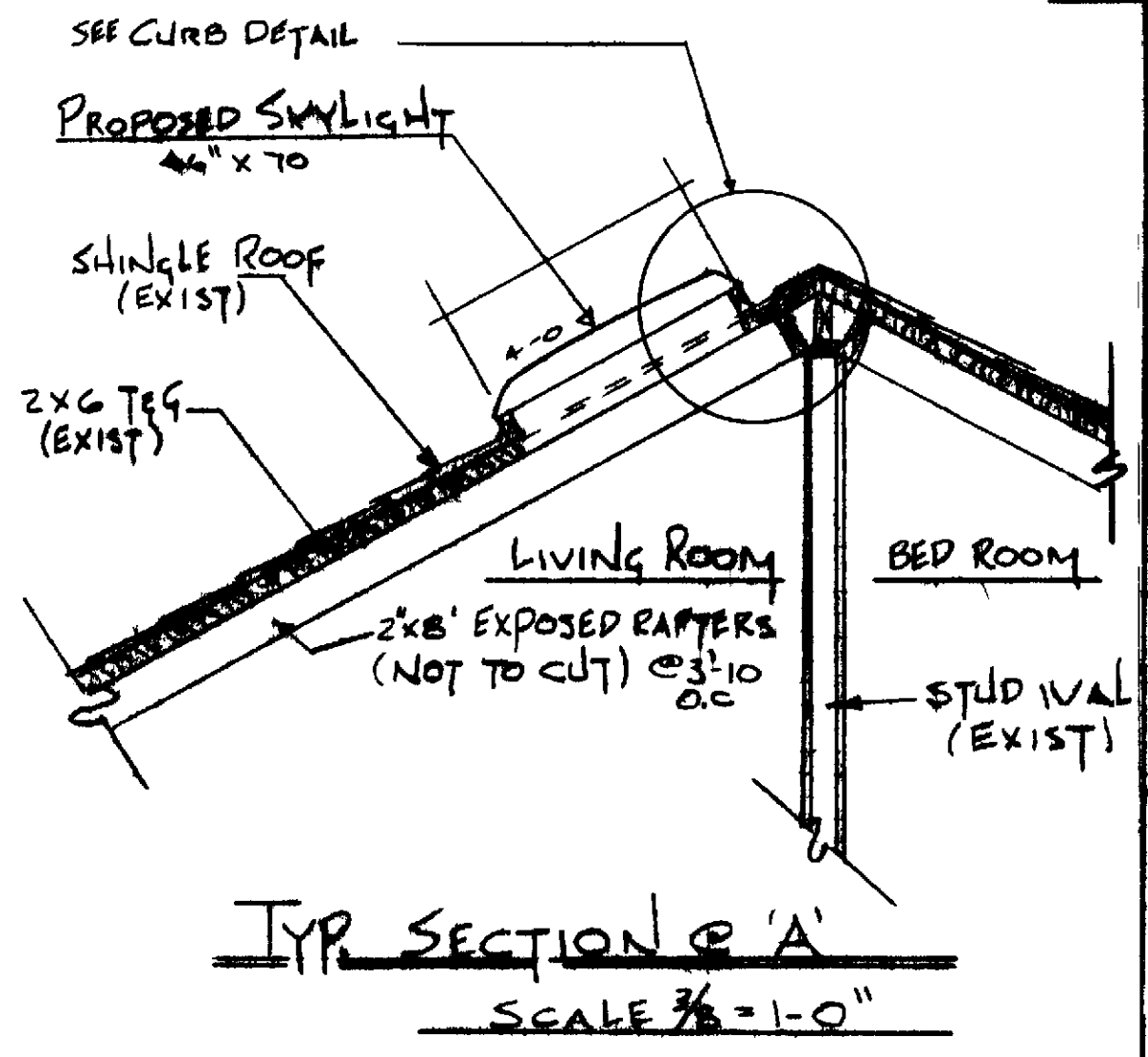

APPROVED SKYLIGHT SIZES & LOCATIONS	
1 LIVING ROOM	4x8
2 KITCHEN	4x4'
3 BED ROOMS 2 & 3	2x4
4. BED ROOM MASTER	4x4
5 BATH ROOMS	2x4
6. DINNING ROOM	4x4
7 ENTRY HALL	2x4

NOTE
SKYLIGHTS MAY BE INSTALLED IN ANY COMBINATION NOT TO EXCEED TITLE XXIV OF THE CALIFORNIA STATE ENERGY CONSERVATION STANDARD

VILLASERENA SAN MARCO
 PLAN C-12 SKYLIGHTS
 PLAN C-11 VILLA REPOSA TRAILHEAD
 LEISURE WORLD
 STANDARD PLAN 170
 PROFESSIONAL COMMUNITY MGT.
 APPROVED
 DATE JANUARY 29, 1982
 PCM INC PO BOX 2200, LAGUNA HILLS, CALIF. 92653
 170